

ECAM

End Cap Assembly Machine

The Massman ECAM can be purchased in either a semi-automatic manual load configuration or as a fully automatic assembly system with seamed cartridges loaded directly from a Massman seaming machine. End caps made of metal, plastic, moldable adhesive or felt in various shapes can be accommodated in diameters of 2 to 4 inches (50 to 100mm) with semi-standard machinery. Machines are PLC controlled and HMI interfaced with automatic servo changeovers where possible, often having 1-minute changeovers for dimensional variations. Cycle rates of 20, 30 and even 60 ppm are typical.

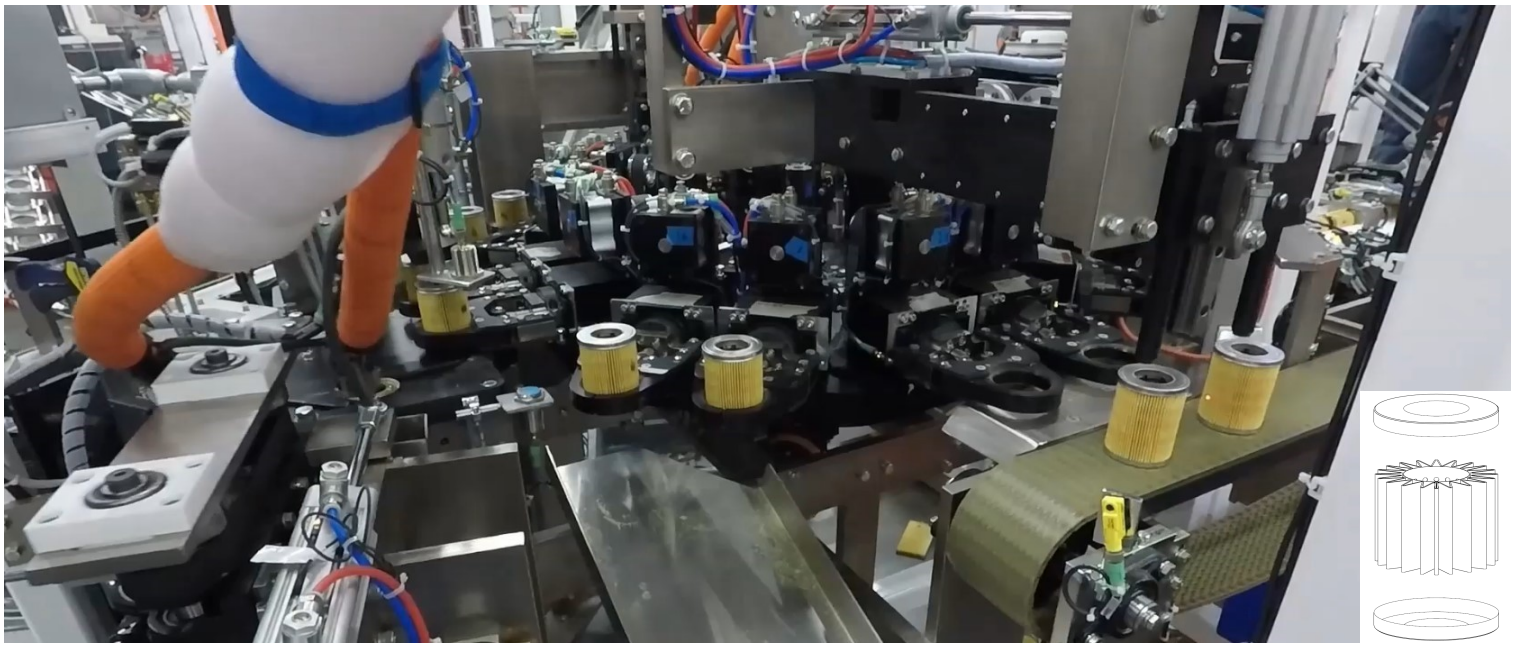

AVAILABLE MODELS

- ECAM-E (Embedding with re-melt plastic)
- ECAM-M (Mold formed end caps)
- ECAM-P (Potted with thixo or non-thixotropic adhesive)
- ECAM-U (Ultrasonic weld attached)

Over the past 30 years, Massman filter assembly systems have earned a reputation for proven performance and continuous improvement. With a wide range of product capabilities, Massman has the right solution to help you achieve maximum efficiency and lower production costs.

ECAM Specifications

ECAM Design Capability

| Characteristic | ECAM-E | ECAM-M | ECAM-P | ECAM-U |
|---------------------------|--|--------|--------|--------|
| Slit / Filter Height | 1.50" - 8.00" (38mm - 200mm) | | | |
| Filter / End Cap Diameter | 2.0" - 4.0" (<10") (50mm - 100mm) (<250mm) | | | |
| Center Tubes | With or Without | | | |
| Cycle Rate | 20 to 60 ppm (Application Specific) | | | |



ECAM Dimensional Layout

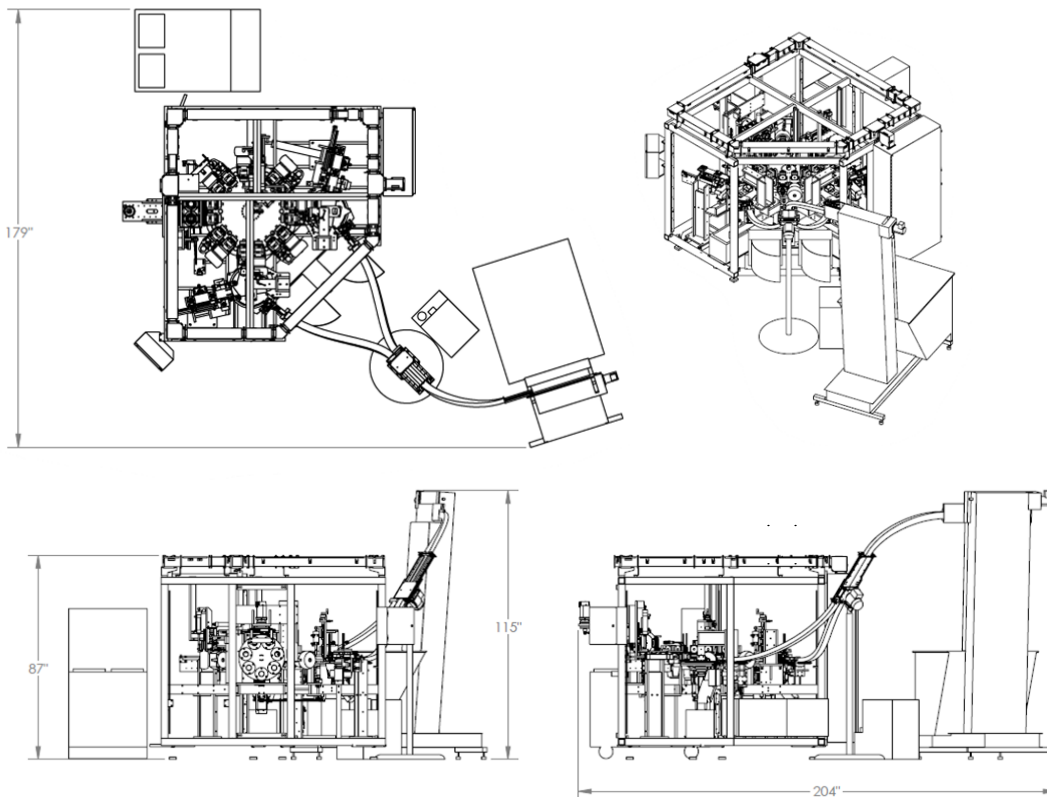

* Listed dimensions are only for reference and are subject to change without notice.

** ECAM equipment can conform to OSHA, UL, CUL, CSA, NFPA and CE standards.

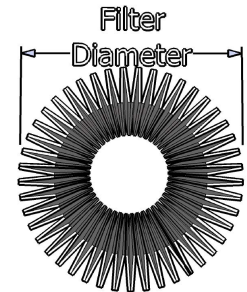
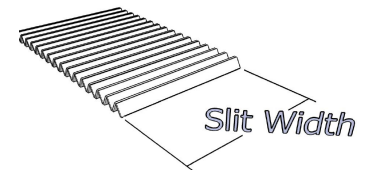

Features

- Standard designs, proven process built for your unique filter requirements
- For water, air, oil, alcohol, medical applications, and fuel filtration
- World Class Manufacturing built to your country's build standards
- Each part is stamped with a unique part number, and then painted, plated or anodized
- 24-hour phone support
- Dedicated spare parts department
- After sale onsite service